

Panel mounted inlet - Part no. 393



- screw terminals
- with hinged lid

Protection type	IP 44
Ampere	16A
Poles	4p
Voltage	230V
Hertz	50-60 Hz
Earth position	9h
Contact	standard
Connection technology	Screw terminals
Shutter	

Std. Pack. 10 Qty.

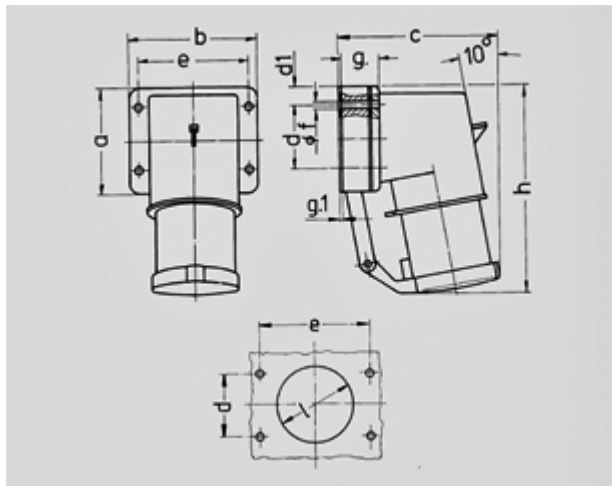

Drawing	Amp.	16		32		
2 MB 43	Poles	4	5	3	4	5
Dim. in mm	a	85	85	75	75	75
	b	85	85	90	90	90
	c	104	106	115	115	117
	d	64	64	45	45	45
	d1	10	10	13	13	13
	e	64	64	78	78	78
	f	5,5	5,5	5,5	5,5	5,5
	g.	27	27	27	27	27
	g.1	2	2	1	1	1
	h	140	140	150	150	150
	l	50	50	55	55	55
Terminal for cond. cross		1	1	2,5	2,5	2,5
section (mm²) min.-max.		-2,5	-2,5	-6	-6	-6