

# Technical data sheet

All right reserved Landa illuminotecnica S.p.A.  
will reserve to change the specific note without  
any written notice.

**LANDA**<sup>®</sup>  
illuminotecnica

## Beam

Article 456LL20H Warm White

Product type wall light

Body material

Die-casting aluminium EN47100, prior the painting process, washed with stones. Painting made by polyester powder with high resistant against oxidation.

Opal polycarbonate and silicon gaskets

Screws in A2 stainless steel

Powered by Citizen AC DC 220-240V

Transformer **not required**

IP65

Powered by  
Citizen Electronics  
2280LM – 1460 lx at 1mt  
20W 220 - 240V  
3000K RA80  
Dimmable: Yes-Triac  
Symmetric - Beam 60°



++



Colours available:

Graphite



nhg

Metalgrey



all

Oxide



oxi

White



bgg

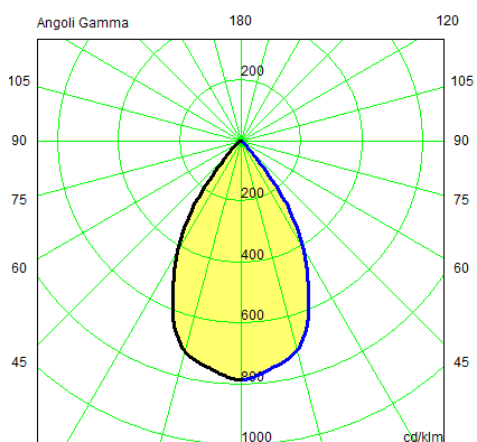
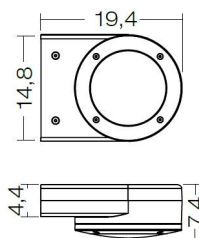

LANDA ILLUMINOTECNICA S.p.A.

Via Rosmini, 13/15 - 25067 Lumezzane S.A. - Brescia - Italy - Tel. +39 030 89 20 966 - Fax +39 030 8921003

e-mail: info@landa.it - P.IVA IT00688140987 - Cod. Fiscale 02125310173

www.landa.it