



With integrated PSU adapter.

LV 18° / 37° / 60°

LV 80° (on request)

AVAILABLE COLOURS



| Nr | Housing | Front ring |
|-------|---------------------|------------|
| XX=61 | Matt white RAL 9016 | Gold |
| XX=62 | Matt white RAL 9016 | Black |
| XX=65 | Matt white RAL 9016 | White |
| XX=71 | Matt black RAL 9005 | Gold |
| XX=72 | Matt black RAL 9005 | Black |
| XX=76 | Matt black RAL 9005 | White |

Odion XL (Gen2)

SPECIFICATIONS

| | |
|----------------------------|---|
| Beam angle (FWHM) | 18° / 37° / 60° (80° on request) |
| UGR (4H8H 70/50/20) | <19 (18° + 37°) |
| Fixture material | Die cast aluminium / Polycarbonate |
| Environment | Indoor |
| IK rate | IK03 |
| Operating temperature (Ta) | -20°C / +45°C ¹ |
| Safety marks | EN60598 / EN62031 / EN 62471 |
| EMC compliance | EN55015 |
| Colour consistency (SDCM) | MacAdam step 3 |
| Warranty | 7 years * (within the European Union and the countries of the Free Trade Association for products delivered after 1 May 2015) |
| Energy class | A+ |

This luminaire contains built-in LED lamps. There are no exchangeable parts inside the luminaire. EU 874/2012

¹ In applications with a flat roof (f.i. car showrooms) the temperatures may exceed 45°C. Please ask our sales office for a special driver.



Ask our sales department about the possibilities for:
- Extra LED options from the LUXEON Stylist Series

IP20

CRI80/97 VARIATIONS

| | |
|--------------------------------|--------|
| Odion XL LV 3000K CRI80 5000LM | page 3 |
| Odion XL LV 4000K CRI80 5700LM | page 3 |
| Odion XL LV 3000K CRI97 3750LM | page 3 |

CRI80/97 CHOOSE YOUR LV LUMEN OUTPUT

| | mA | W | Lumen Output | | | Lumen / Watt | | | Driver types | | | |
|------------------------|------|------|--------------|-------|-------|--------------|-------|-------|---------------------|-----------|------------|------------|
| | | | CRI80 | CRI80 | CRI97 | CRI80 | CRI80 | CRI97 | CRI80 | CRI97 | CRI80/97 | CRI80/97 |
| | | | 3000K | 4000K | 3000K | 3000K | 4000K | 3000K | No dim | No dim | Dali | Casambi |
| <i>Special request</i> | 900 | 35,5 | 3700 | 4100 | 2700 | 104 | 115 | 76 | 127692 ¹ | OT FIT 40 | On request | On request |
| <i>Special request</i> | 1050 | 41,7 | 4200 | 4700 | 3000 | 101 | 113 | 72 | 127692 ¹ | OT FIT 40 | On request | On request |
| Standard | 1200 | 50,5 | 5000 | 5700 | 3250 | 99 | 113 | 64 | 127692 ¹ | 127692 | On request | On request |
| <i>Special request</i> | 1400 | 57,2 | 5600 | 6300 | 3750 | 98 | 110 | 66 | 127310 | 127692 | On request | x |

¹ Alternative integrated driver GA-016 G3 on request.

DIMENSIONS

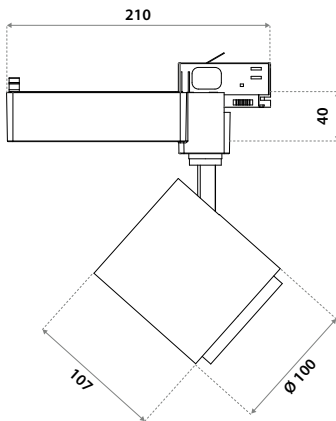

TRACKS

On request! Ask our sales department about the possibilities.

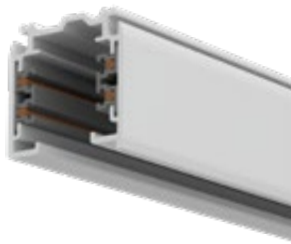

HONEYCOMB ACCESSORY

| Description | Type | Item code |
|------------------|-----------------|--------------|
| Honeycomb filter | By our assembly | 009C03BL0000 |



Reduces the light output by ~25% compared to clear glass.

ODION XL

3000K/4000K

ITEM SPECIFICATIONS (PART A)

| Description | 18° | | 37° | | 60° | | mA |
|-----------------------------|--------------|------|--------------|------|--------------|------|------|
| | Item code | UGR | Item code | UGR | Item code | UGR | |
| Odion XL 5000Lm 3000K CRI80 | 350403XXHA02 | 25.3 | 350403XXHB02 | 26.6 | 350403XXHC02 | 25.9 | 1200 |
| Odion XL 5700Lm 4000K CRI80 | 350403XXHD02 | 25.8 | 350403XXHE02 | 27.0 | 350403XXHF02 | 26.3 | 1200 |
| Odion XL 3750Lm 3000K CRI97 | 350403XXHR02 | 24.3 | 350403XXHS02 | 25.6 | 350403XXHT02 | 24.9 | 1400 |

ITEM SPECIFICATIONS (PART A)

| Description | W | Lm | Lm/W | CRI (typ.) | Pf | Ripple | Inrush current | B-16A Fuse | Safety class | Energy class |
|-----------------------------|------|------|------|------------|------|--------|----------------|------------|--------------|--------------|
| Odion XL 5000Lm 3000K CRI80 | 50,5 | 5000 | 99 | 82 | 0.95 | <3% | 5A 50µS | 50 | I | A+ |
| Odion XL 5700Lm 4000K CRI80 | 50,5 | 5700 | 113 | 82 | 0.95 | <3% | 5A 50µS | 50 | I | A+ |
| Odion XL 3750Lm 3000K CRI97 | 57,2 | 3750 | 66 | 97 | 0.95 | <3% | 5A 50µS | 50 | I | A+ |

ITEM SPECIFICATIONS (PART C)

| Description | Weight | Dimensions single carton | Quantity per carton | Expected lifespan (25°C) | | |
|-------------|---------|--------------------------|---------------------|--------------------------|------------|------------|
| | | | | L70B50 | L80B50 | L90B50 |
| Odion XL | 1586 gr | 251x241x123 mm | 12 pcs | 70.000 hrs | 70.000 hrs | 70.000 hrs |

NEW STANDARDS REQUIRE NEW LEDS

TM-30 (new color norm): The Illuminating Engineering Society (IES) has published a new Technical Memorandum – TM-30-15 entitled “IES Method for Evaluating Light Source Color Rendition” – that promises to supplant CRI as a color metric. TM-30 relies on separate fidelity and gamut metrics, as well as a set of color samples that is more representative of real-world objects, as opposed to the pastel samples that were primarily used for the baseline CRI metric that was sometimes called Ra. The new color metric is intended to fairly and accurately characterize both LED-based solid-state lighting (SSL) and legacy sources.



Desaturated

CRI = 80 / R_g = 92



Red-Enhanced

CRI = 98 / R_g = 103

SPECIAL LEDS AVAILABLE

| | CCT | CRI | R9 | RF | RG | R15 | TLCI | DOWNLIGHTS SMALL | | DOWNLIGHTS LARGE | | DOWNLIGHTS LARGE | | ITEM CODE |
|-----------------------------|-------|-----|----|----|-----|-----|------|------------------|------|------------------|------|------------------|------|--------------|
| | | | | | | | | MA | LM | MA | LM | MA | LM | |
| CRI80 | 2700K | 82 | 5 | 82 | 92 | 75 | 69 | 350 mA | 1550 | 700 mA | 2900 | 1200 mA | 4800 | 51-4028-27-1 |
| CRI80 | 3000K | 82 | 5 | 81 | 93 | 75 | 66 | 350 mA | 1625 | 700 mA | 3000 | 1200 mA | 5000 | 51-4028-30-1 |
| CRI80 | 4000K | 82 | 5 | 81 | 93 | 74 | 66 | 350 mA | 1700 | 700 mA | 3400 | 1200 mA | 5700 | 51-4028-40-1 |
| CRI97 | 2700K | 97 | 93 | 96 | 103 | 99 | 97 | 350 mA | 1150 | 800 mA | x | 1400 mA | x | 50-3031-27 |
| CRI97 | 3000K | 97 | 96 | 95 | 103 | 100 | 97 | 350 mA | 1250 | 800 mA | 2500 | 1400 mA | 3750 | 50-3031-30 |
| CRI97 | 4000K | 97 | 96 | 95 | 103 | 100 | 97 | 350 mA | 1350 | 800 mA | x | 1400 mA | x | 50-3031-40 |
| CrispWhite | 3000K | 90 | 61 | 87 | 102 | 89 | 83 | 350 mA | 780 | 900 mA | 2300 | 1400 mA | 3550 | 51-4029-30 |
| CrispColor | 2700K | 94 | 96 | 93 | 106 | 95 | 93 | 350 mA | 780 | 900 mA | 2350 | 1400 mA | 3550 | 51-4047-27 |
| CrispColor | 3000K | 91 | 93 | 91 | 103 | 96 | 96 | 350 mA | 825 | 900 mA | 2500 | 1400 mA | 3750 | 51-4048-30 |
| CrispColor | 3250K | 93 | 95 | 90 | 101 | 96 | 97 | 350 mA | 870 | 900 mA | 2600 | 1400 mA | 3950 | 51-4049-FN |
| CrispColor | 3500K | 95 | 96 | 91 | 102 | 95 | 96 | 350 mA | 880 | 900 mA | 2600 | 1400 mA | 4000 | 51-4050-35 |
| CrispColor | 4000K | 95 | 96 | 90 | 101 | 95 | 96 | 350 mA | 1050 | 900 mA | 2700 | 1400 mA | 4700 | 51-4051-40 |
| CrispColor | 5000K | 95 | 96 | 88 | 99 | 94 | 95 | 350 mA | 850 | 900 mA | 2800 | 1400 mA | 3800 | 51-4052-00 |
| Produce | 3000K | 91 | 93 | 91 | 103 | 96 | 96 | 350 mA | 725 | 900 mA | 2500 | 1400 mA | 3300 | 51-4041-00 |
| Red Meat | 1800K | 82 | 81 | 77 | 119 | 95 | 60 | 350 mA | 515 | 900 mA | 1750 | 1400 mA | 2350 | 51-4042-00 |
| Marbled Meat | 3000K | 63 | 32 | 78 | 115 | 46 | 72 | 350 mA | 475 | 900 mA | 1600 | 1400 mA | 2150 | 51-4043-00 |
| Fish | 6500K | 96 | 96 | 89 | 98 | 94 | 96 | 350 mA | 825 | 900 mA | 2800 | 1400 mA | 3750 | 51-4044-00 |
| Bread & Pastries | 2700K | 92 | 54 | 89 | 96 | 86 | 91 | 350 mA | 770 | 900 mA | 2600 | 1400 mA | 3500 | 51-4045-00 |
| AtmoSphere | 2200K | 92 | 55 | 90 | 99 | 87 | 88 | 350 mA | 780 | 900 mA | 2350 | 1400 mA | 3550 | 51-4046-00 |



2700K

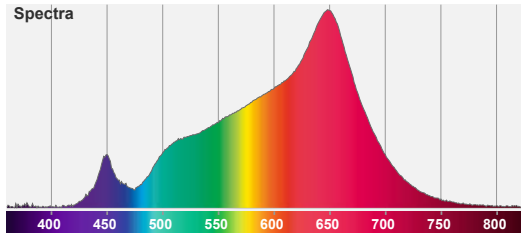
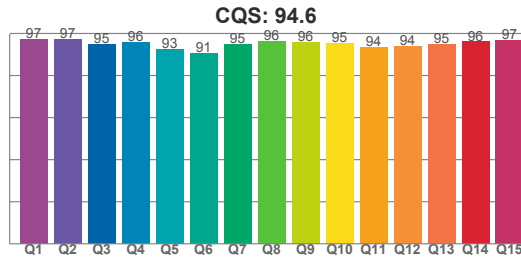
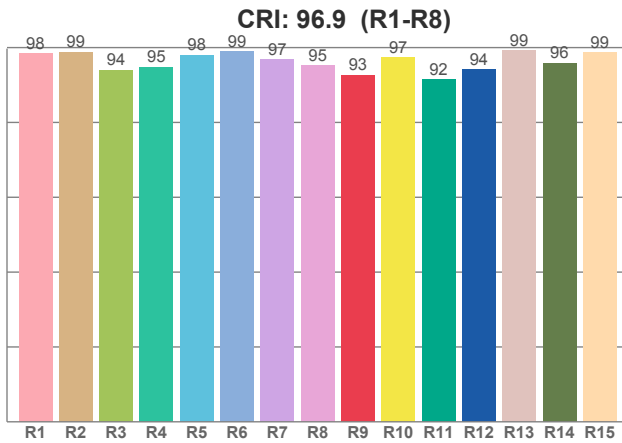

| CCT | CRI | CRI R9 | TM30 Rf | TM30 Rg | CQS |
|-------|------|--------|---------|---------|------|
| 2700K | 96.9 | 92.7 | 96.0 | 102.6 | 94.6 |

3000K

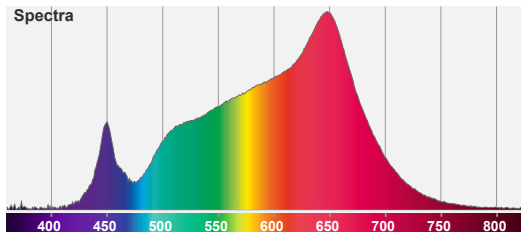
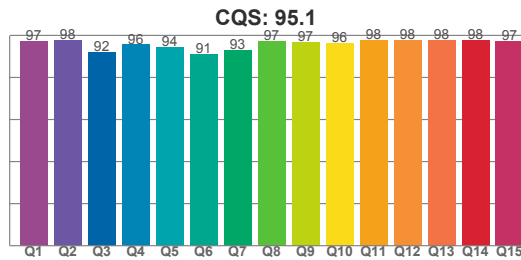
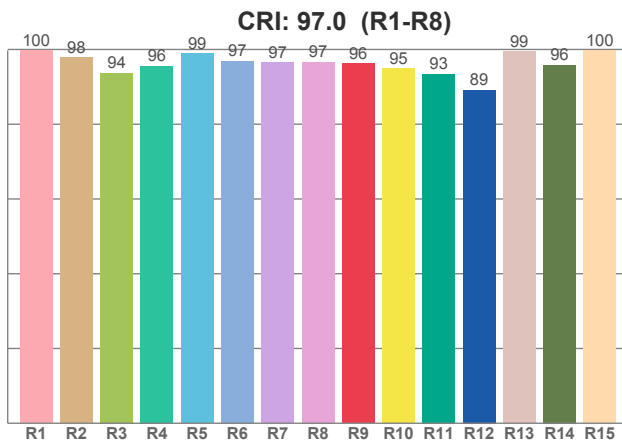

| CCT | CRI | CRI R9 | TM30 Rf | TM30 Rg | CQS |
|--------|------|--------|---------|---------|------|
| 3000 K | 97.0 | 96.2 | 95.0 | 103.3 | 95.1 |

4000K

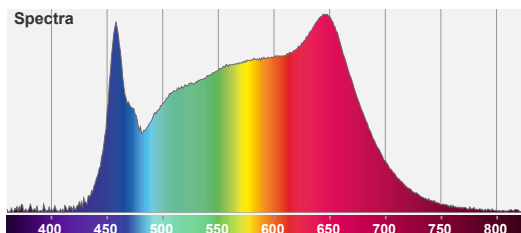
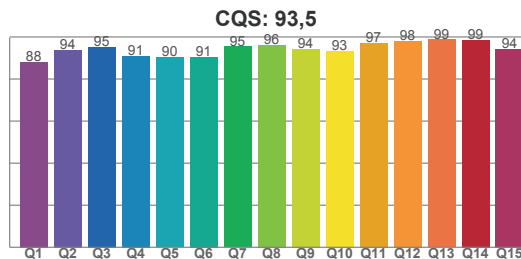
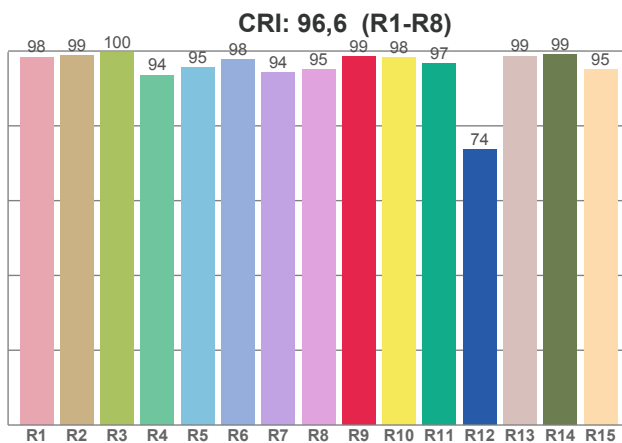

| CCT | CRI | CRI R9 | TM30 Rf | TM30 Rg | CQS |
|-------|------|--------|---------|---------|------|
| 4000K | 96.6 | 98.5 | 88.3 | 96.2 | 93.5 |