



Coreline tempo X-Large

BVP140 LED480-4S 40K3/740 PSU OFA52

CORELINE TEMPO X-LARGE - LED module 48000 lm - 740 neutral white - Optiflux asymmetrical axis angle 52°

Coreline tempo X-Large delivers on the Coreline promise of innovative, easy to use and high quality luminaires; Designed to be a plug-and-play 1:1 retrofit of conventional floodlights with short payback time, its extensive options open a lot more opportunities to optimize performance and savings in many different applications, such as recreational sports facilities, industrial/commercial areas, parking lots, etc.; This floodlight is equipped with the QR code-based Philips Service tag, which supports installation and maintenance work and enables you to create your digital library of lighting assets and spare parts.; As an option, Coreline tempo X-Large is also ready to be connected to lighting asset management systems such as Interact City and Interact Sports recreational

Product data

General Information			
Lamp family code	LED480 [LED module 48000 lm]	Cable	Cable 1.0 m with plug Wieland/Adels compatible 3-pole
Light source color	740 neutral white	Protection class IEC	Safety class I
Light source replaceable	Yes	Flammability mark	For mounting on easily flammable surfaces
Number of gear units	2 units	CE mark	CE mark
Driver/power unit/transformer	Power supply unit	ENEC mark	ENEC plus mark
Driver included	Yes	Warranty period	5 years
Optical cover/lens type	Flat glass	Optic type outdoor	Optiflux asymmetrical axis angle 52°
Luminaire light beam spread	103° - 8° x 57°	Remarks	* At extreme ambient temperatures the luminaire might automatically dim down to protect components
Control interface	-		
Connection	Connection unit 3-pole		

Coreline tempo X-Large

Constant light output	No
Number of products on MCB of 16 A type B	4
EU RoHS compliant	Yes
Light source engine type	LED
Serviceability class	Class C, luminaire without serviceable parts, not serviceable
Product family code	BVP140 [CORELINE TEMPO X-LARGE]

Light Technical

Upward light output ratio	0
Standard tilt angle posttop	0°
Standard tilt angle side entry	0°

Operating and Electrical

Input Voltage	220 to 240 V
Input Frequency	50 to 60 Hz
Inrush current	53 A
Inrush time	0.3 ms
Power Factor (Min)	0.99

Controls and Dimming

Dimmable	No
----------	----

Mechanical and Housing

Housing Material	Aluminum die cast
Reflector material	-
Optic material	Acrylate
Optical cover/lens material	Glass
Fixation material	Steel
Mounting device	Mounting bracket adjustable
Optical cover/lens shape	Flat
Optical cover/lens finish	Clear
Overall length	540 mm
Overall width	560 mm
Overall height	70 mm
Effective projected area	0.26 m ²
Color	Gray
Dimensions (Height x Width x Depth)	70 x 560 x 540 mm (2.8 x 22 x 21.3 in)

Approval and Application

Ingress protection code	IP66 [Dust penetration-protected, jet-proof]
-------------------------	---

Mech. impact protection code	IK08 [5 J vandal-protected]
Surge Protection (Common/Differential)	-

Initial Performance (IEC Compliant)

Initial luminous flux (system flux)	40320 lm
Luminous flux tolerance	+/-7%
Initial LED luminaire efficacy	137 lm/W
Init. Corr. Color Temperature	4000 K
Init. Color Rendering Index	>70
Initial chromaticity	(0.38, 0.38) SDCM <5
Initial input power	295 W
Power consumption tolerance	+/-11%

Over Time Performance (IEC Compliant)

Control gear failure rate at median useful life 75000 h	7.6 %
Control gear failure rate at median useful life 100000 h	10 %
Lumen maintenance at median useful life* 75000 h	L90
Lumen maintenance at median useful life* 100000 h	L96

Application Conditions

Ambient temperature range	-40 to +50 °C
Performance ambient temperature Tq	25 °C

Product Data

Full product code	871869987278600
Order product name	BVP140 LED480-4S 40K3/740 PSU OFA52
EAN/UPC - Product	8718699872786
Order code	912300024334
Numerator - Quantity Per Pack	1
Numerator - Packs per outer box	1
Material Nr. (12NC)	912300024334
Net Weight (Piece)	17.000 kg



Coreline tempo X-Large

Dimensional drawing

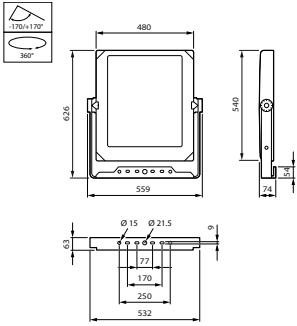

CoreLine Tempo BVP110/120/125/130/140

Photometric data

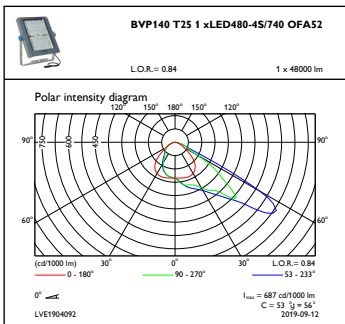

OFPC1_BVP140T251xLED480-4S740OFA52

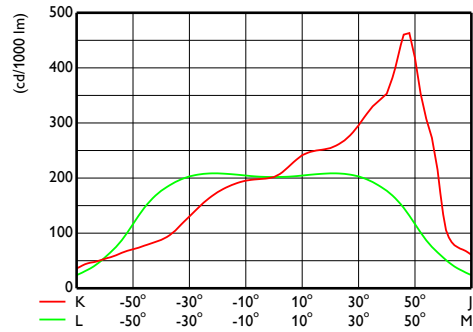

OFCS1_BVP140T251xLED480-4S740OFA52

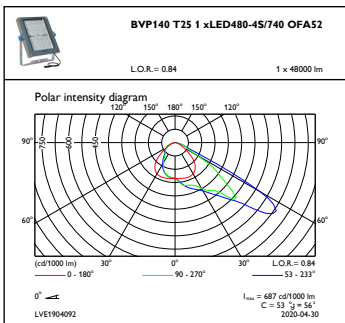

OFPC1_BVP140T251xLED480-4S740OFA52

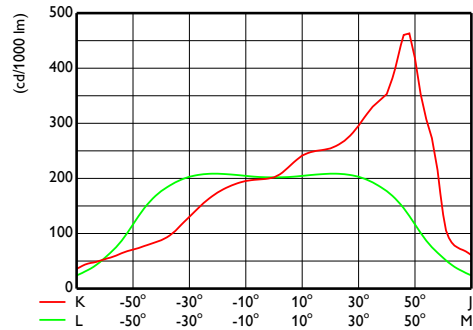

OFCS1_BVP140T251xLED480-4S740OFA52

Coreline tempo X-Large

