

FEATURES

- High end aluminum heatsink with a unique elegant design
- PCB with a high power Lumileds Powerleds in 2700, 3000K and 4000K
- Illuxtron patented optical lens system that makes pin-hole light possible
- Anti glare cap that ensures no stray light. The total light opening is only 8mm!

Bartenbach
lighting optics



SPRINGS

Standard with WS springs (gyproc/metal). Also available as above with CS springs (concrete).



COLOURS

Available colours:



Matt white RAL 9016 (XX=MW)
Matt black RAL 9005 (XX=BL)

Pointer 40

Fixed

SPECIFICATIONS

Beam angle (FWHM)	35° (45° FWTM) / 60° (80° FWTM)
Fixture material	Die cast aluminium
Environment	Indoor
IK rate	IK10
Operating temperature (Ta)	-20°C / +45°C ¹
Safety marks	EN60598 / EN62031 / EN62471
EMC compliance	EN55015
Colour consistency (SDCM)	MacAdam step 3
Warranty	7 years * (within the European Union and the countries of the Free Trade Association for products delivered after 1 May 2015)
Energy class	A

This luminaire contains built-in LED lamps. There are no exchangeable parts inside the luminaire. EU 874/2012

¹ In applications with a flat roof (fi. car showrooms) the temperatures may exceed 45°C. Please ask our sales office for a special driver.



Only when the product is installed in a closed ceiling it may be exposed to water splashes, and only on its front side.

IP20

IP44

POINTER 40 VARIATIONS

Pointer 40 LV	100-240V	incl. power supply	page 3
Pointer 40 LV-C	500mA	to be connected to a central power supply	page 4

DIMENSIONS

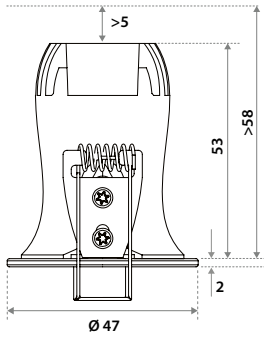

HOLE SIZE

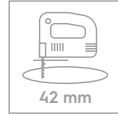

Using WS (wire) springs (gyproc/metal)
For 1-20 mm ceiling thickness.
Recess depth 58 mm (incl. 5mm space for air ventilation).

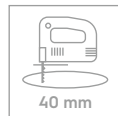

Using CS (concrete) springs (concrete/gyproc)
For 5-58 mm ceiling thickness.
Recess depth 58 mm (incl. 5mm space for air ventilation).

FIRE RATING TUBE

Description	Item code	Hole size	time
Fire rating tube 40	009E03MW0000	ø45x61mm	90 min.



⚠ Only in combination with WS (wire) springs versions.

POINTER 40 (dimmable - incl. individual power supply)

100-240V

Downlight incl. PSU

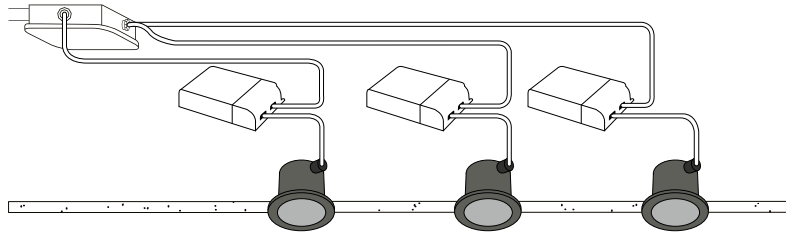
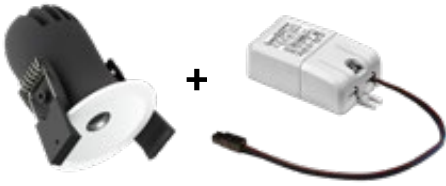

ITEM SPECIFICATIONS (PART A)

Description	Item code WS	Item code CS	Input	W	Lm	Lm/W	CRI (typ.)	UGR	Pf	Ripple	Inrush current	B-16A Fuse
Pointer 40 LV 35° 350 Lm 2700K No dim	062703XXWA13	062703XXLU13	100-240V	6,6	350	53	85	7.4	0.6	<3%	20A 170µS	50 pcs
Pointer 40 LV 35° 375 Lm 3000K No dim	062703XXWB13	062703XXLV13	100-240V	6,6	375	57	85	7.6	0.6	<3%	20A 170µS	50 pcs
Pointer 40 LV 35° 400 Lm 4000K No dim	062703XXWC13	062703XXLW13	100-240V	6,6	400	61	85	7.9	0.6	<3%	20A 170µS	50 pcs
Pointer 40 LV 60° 400 Lm 2700K No dim	062703XXWD13	062703XXLX13	100-240V	6,6	400	61	85	17.8	0.6	<3%	20A 170µS	50 pcs
Pointer 40 LV 60° 425 Lm 3000K No dim	062703XXWE13	062703XXLY13	100-240V	6,6	425	64	85	18.0	0.6	<3%	20A 170µS	50 pcs
Pointer 40 LV 60° 450 Lm 4000K No dim	062703XXWF13	062703XXLZ13	100-240V	6,6	450	68	85	18.2	0.6	<3%	20A 170µS	50 pcs
Pointer 40 LV 35° 350 Lm 2700K Triac dim	062703XXWN13	-	100-240V	6,6	350	53	85	7.4	0.96	<20%	2A 50µS	50 pcs
Pointer 40 LV 35° 375 Lm 3000K Triac dim	062703XXWP13	-	100-240V	6,6	375	57	85	7.6	0.96	<20%	2A 50µS	50 pcs
Pointer 40 LV 35° 400 Lm 4000K Triac dim	062703XXWQ13	-	100-240V	6,6	400	61	85	7.9	0.96	<20%	2A 50µS	50 pcs
Pointer 40 LV 60° 400 Lm 2700K Triac dim	062703XXWR13	-	100-240V	6,6	400	61	85	17.8	0.96	<20%	2A 50µS	50 pcs
Pointer 40 LV 60° 425 Lm 3000K Triac dim	062703XXWS13	-	100-240V	6,6	425	64	85	18.0	0.96	<20%	2A 50µS	50 pcs
Pointer 40 LV 60° 450 Lm 4000K Triac dim	062703XXWT13	-	100-240V	6,6	450	68	85	18.2	0.96	<20%	2A 50µS	50 pcs

ITEM SPECIFICATIONS (PART B)

Description	Safety class	Energy class	Weight	Dimensions single carton	Quantity per pallet	Expected lifespan B10 reported (25°C)		
						L70B10	L80B10	L90B10
Pointer 40 LV	II	A	200 gr	105x105x61 mm	42 pcs	>60.000 hrs	>60.000 hrs	>60.000 hrs

All values are measured at 230V (+/- 7%)

INCL. PSU

PSU TCI 122602 No dim 68x35x22 mm



Cable
150 mm

POINTER 40 (dimmable - excl. central power supply)

500 mA

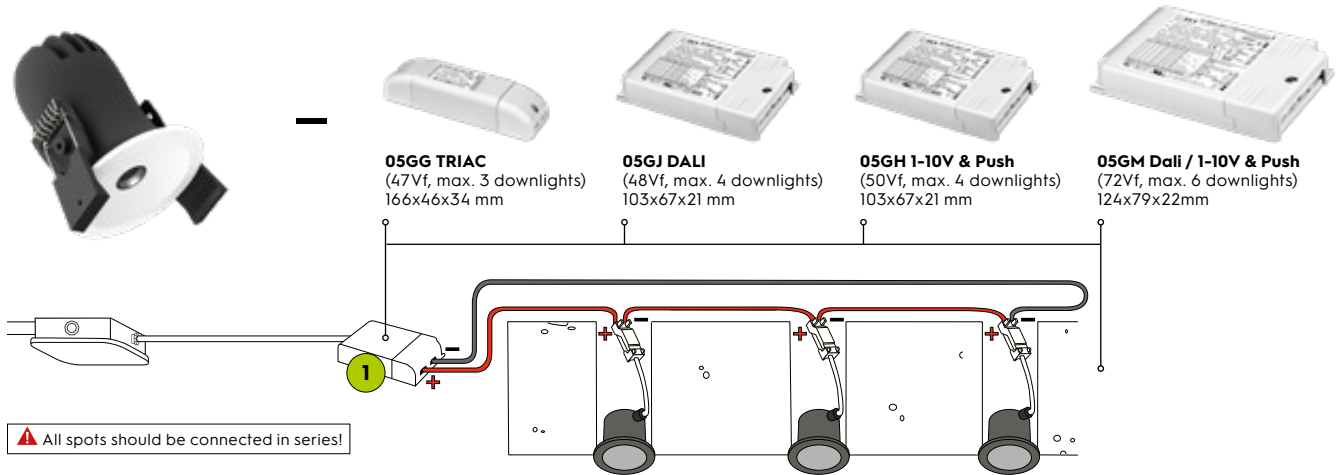

ITEM SPECIFICATIONS (PART A)

Description	Item code WS	Item code CS	Input	Vf	W	Lm	Lm/W	CRI (typ.)	UGR	Pf	Ripple	Inrush current	B-16A Fuse
Pointer 40 LV-C 500mA 35° 350 Lm 2700K Dim	062703XXWN11	062703XXLG11	500mA	11,4	5,7	350	61	85	7.4	x	x	x	x
Pointer 40 LV-C 500mA 35° 375 Lm 3000K Dim	062703XXWP11	062703XXLH11	500mA	11,4	5,7	375	66	85	7.6	x	x	x	x
Pointer 40 LV-C 500mA 35° 400 Lm 4000K Dim	062703XXWQ11	062703XXLJ11	500mA	11,4	5,7	400	70	85	7.9	x	x	x	x
Pointer 40 LV-C 500mA 60° 400 Lm 2700K Dim	062703XXWR11	062703XXLK11	500mA	11,4	5,7	400	70	85	17.8	x	x	x	x
Pointer 40 LV-C 500mA 60° 425 Lm 3000K Dim	062703XXWS11	062703XXLL11	500mA	11,4	5,7	425	75	85	18.0	x	x	x	x
Pointer 40 LV-C 500mA 60° 450 Lm 4000K Dim	062703XXWT11	062703XXLM11	500mA	11,4	5,7	450	79	85	18.2	x	x	x	x

ITEM SPECIFICATIONS (PART B)

Description	Safety class	Energy class	Weight	Dimensions single carton	Quantity per pallet	Expected lifespan B10 reported (25°C)		
						L70B10	L80B10	L90B10
Pointer 40 LV-C 500mA	III	A	150 gr	105x105x61 mm	42 pcs	>60.000 hrs	>60.000 hrs	>60.000 hrs

ITEM SPECIFICATIONS (PART A)

Description	Item code	Input	Watt	Current	Efficiency	Pf	Ripple	Weight	Inrush current	B-16A Fuse
PSU 24W 500mA Triac (1)	05GG03MLME00	220-240V	24W (47Vf)	500mA	85%	0.97	<3%	138 gr	5A 50µS	50 pcs
PSU 24W 500mA Dali (1)	05GJ03MLME00	220-240V	24W (48Vf)	500mA	87%	0.98	<3%	138 gr	5A 50µS	50 pcs
PSU 25W 500mA 1-10V & Push (1)	05GH03MLME00	220-240V	25W (50Vf)	500mA	90%	0.95	<3%	138 gr	5A 50µS	50 pcs
PSU 35W 500mA Dali / 1-10V & Push (1)	05GM03MLME00	220-240V	35W (72Vf)	500mA	89%	0.95	<3%	218 gr	20A 400µS	50 pcs

All values are measured at 230V (+/- 7%)

INCLUDING CONNECTION BOX

For installation to a central power supply.

